

BLINKY IN DESK UNIT

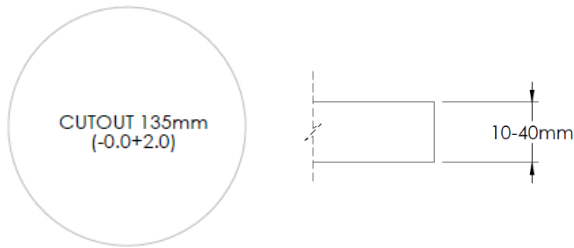

STEP 1 – CUT OUT

Cut – Out Hole in surface 135mm diameter for surface thicknesses of 10mm – 40mm.

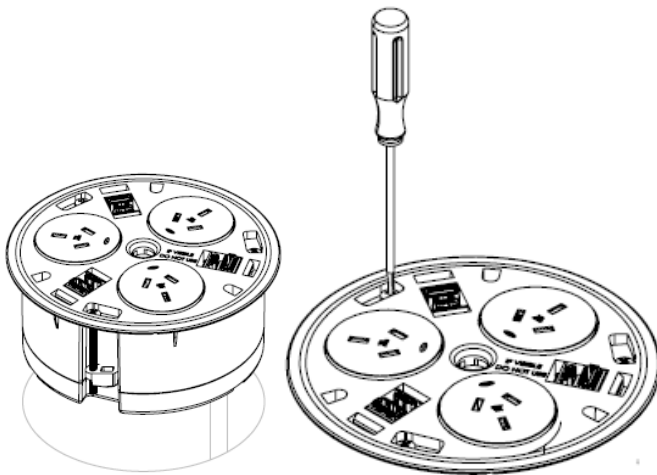

STEP 2 – INSERT / FIXING HOUSING

Fold clamps into provision within housing. Align housing in the cut out and insert housing into desk. Screw the clamps so that they rotate out of the housing. Tighten screws until the assembly clamps down and is secure. The clamps will grip into underside of desk. **DO NOT OVER TIGHTEN - TIGHTEN BY HAND ONLY.**

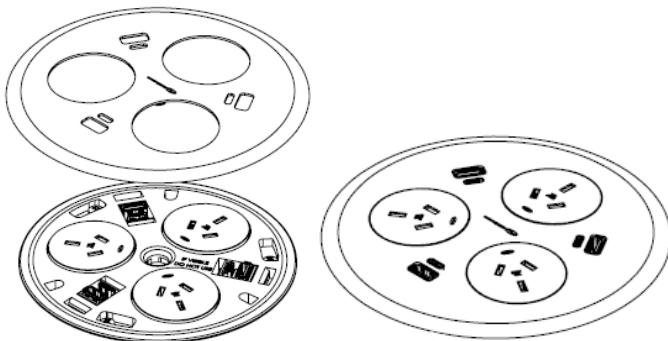

STEP 3 – CLIP ON COVER

Align top cover with Blinky Unit
Push down and check that cover fits flat and even to surface.

STEP 4 – POWER DEVICE

Plug unit into power source,

Available Power Outlets

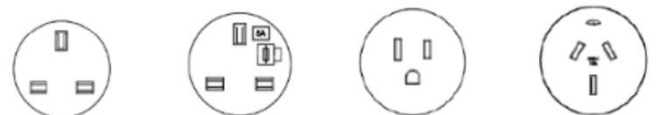

Note:

No user serviceable parts inside. If failure occurs or the supply cord is damaged, please contact CMS Electracom.