

ADDED 0.2MM MATERIAL TO ALL 4 LUGS

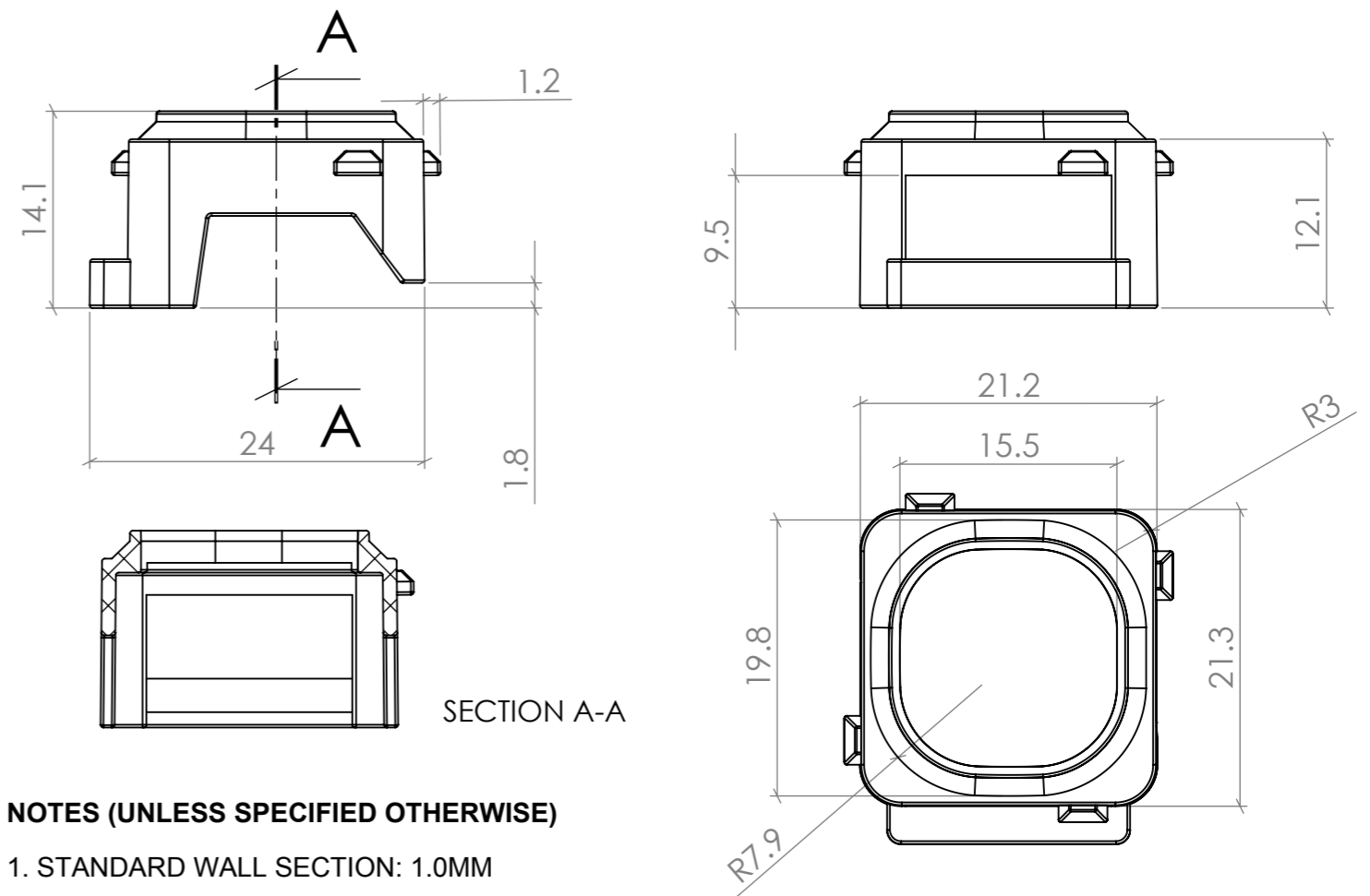

NOTES (UNLESS SPECIFIED OTHERWISE)

- STANDARD WALL SECTION: 1.0MM
- STANDARD DRAFT: 0.5°
- MATERIAL: POLYCARBONATE
GRADE: N/A
FINISH: STANDARD
- ANY SHARP CORNERS SHOULD NOT EXCEED R 0.2MM.
- DIMENSION AND TOLERANCE INFORMATION SHOWN IN THIS DRAWING ARE VITAL TO THE QUALITY OF THE FINISHED PART. PLEASE REFER TO LU387_V2_Adapter clip.IGS FOR 3D INFORMATION.
- MOLDINGS MUST BE SUPPLIED CLEAN AND FREE OF DISTORTIONS AND SURFACE IMPERFECTIONS, FLASH, SCRATCHES, WELD LINES AND BLOOM.
- INJECTION AND GATE PIN LOCATIONS MUST BE PLACED AWAY FROM VISUAL SURFACES AND TOOLING DRAWINGS MUST BE APPROVED BY CMS BEFORE TOOLING.
- PLEASE REFER TO 3D MODEL DRAWING VIEWS FOR VISUAL AND SECONDARY SURFACES.
- ALL DIMENSIONS INSIDE AN OBOURD ARE FOR QA INSPECTION AND MUST BE STRICTLY FOLLOWED FOR PROPER PART FIT AND FUNCTION.
- IF MORE THAN 1 TOOLING CAVITY IS REQUIRED, CAVITY NUMBERS MUST BE PRESENT.
- ANY DIMENSIONS MARKED WITH A * MAY REQUIRE METAL-OFF TUNING AFTER OFF-TOOL SAMPLES HAVE BEEN CHECKED BY CMS ELECTRACOM.

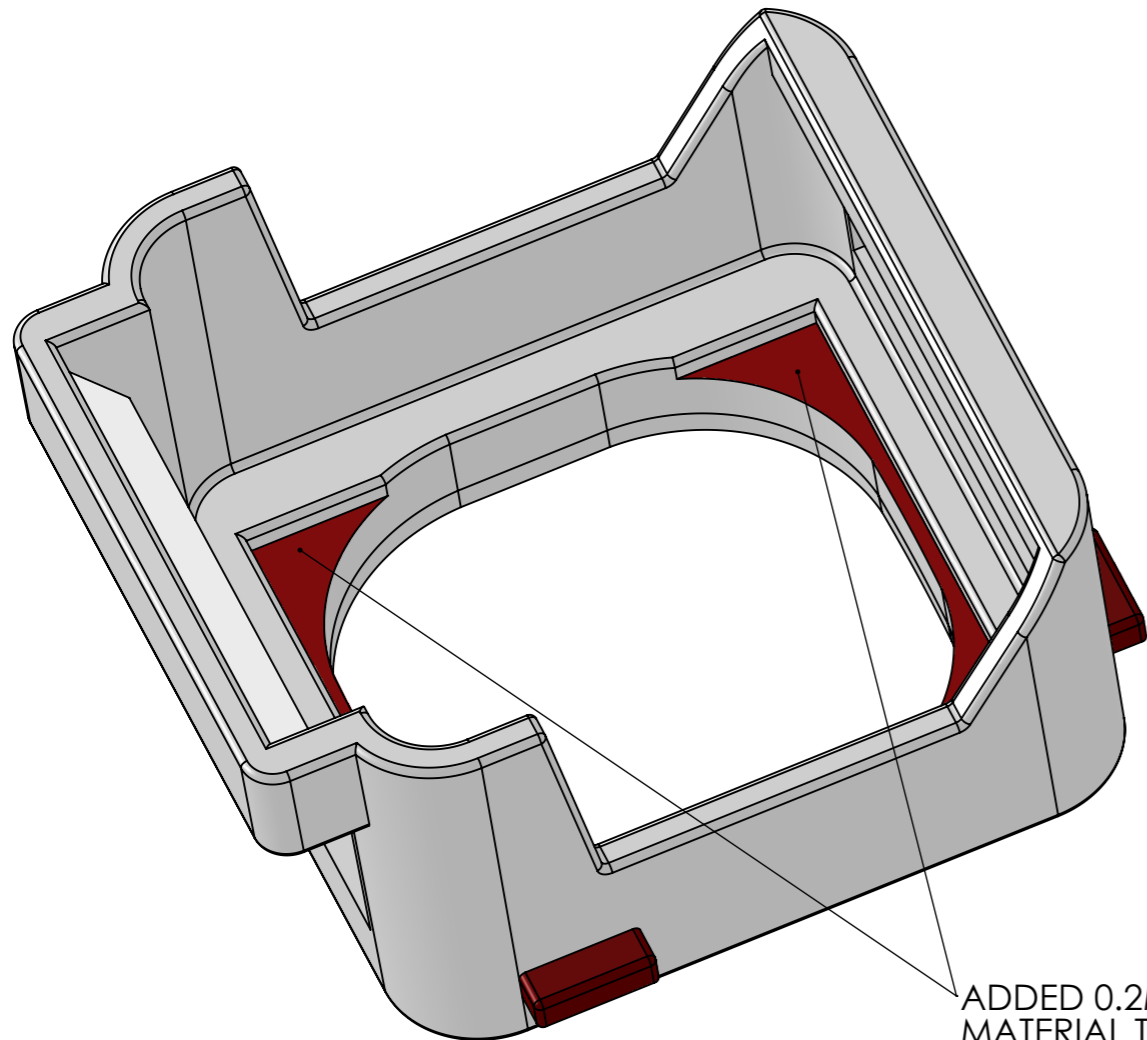

ADDED 0.2MM MATERIAL TO THIS SECTION

REVISION HISTORY		UNLESS OTHERWISE SPECIFIED: DIMENSIONS ARE IN MILLIMETERS		DO NOT SCALE DRAWING		REVISION	
N.	DATE	MODIFICATIONS		TOLERANCES		3	
1	19/11/09	ISSUED FOR MANUFACTURING		LINEAR: ±0.3 ANGULAR: ±0.5°		CMS Electracom	
2	09/04/10	ADDED 0.2mm MATERIAL TO ALL LUGS		DEBUR AND BREAK SHARP EDGES		TITLE: Adapter clip	
3	14/04/10	ADDED 0.2mm MATERIAL TO INSIDE OF PART		THE MATERIAL CONTAINED HEREIN IS THE SOLE PROPERTY OF CMS ELECTRACOM. ANY UNAUTHORIZED REPRODUCTIONS, MODIFICATIONS AND / OR DISTRIBUTION IS STRICTLY PROHIBITED.		DWG NO. LU-387	
4				NAME DATE		PART NO. LU387	
5				Lucky 14/04/10		SCALE 2:1 SHEET 1 OF 1	
6				MATERIAL: Polycarbonate 110		A3	
7				FINISH: Standard			
8							
9							
10							
11							
12							
13							