

# CENTRA RAIL

## 1 CUT OUT

Determine desired orientation/location of rail and cut the hole into the table top. **ENSURE YOU REFER TO CUT OUT DIMENSIONS ON DRAWING AS DIMENSIONS WILL VARY DEPENDING ON YOUR RAIL CONFIGURATION.**

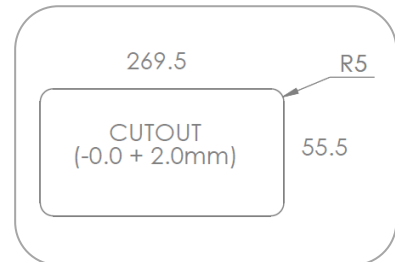

## 2 INSERT RAIL

Fold clamps into provision within housing and insert rail into desk.

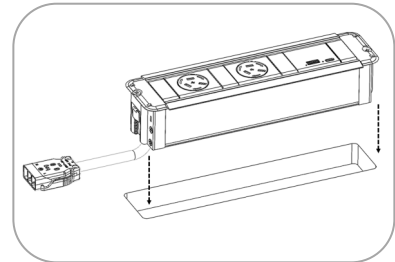

## 3 TIGHTEN SCREWS

Screw up both screws, one at each end of the rail. The clamps will rotate out of the housing as the screws are done up. Tighten screws until the assembly clamps down and is secure. The clamps will grip into underside of desk. **DO NOT OVER TIGHTEN - TIGHTEN BY HAND ONLY.**

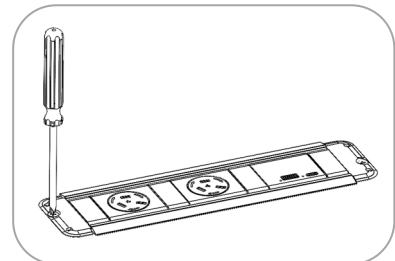

## 4 CLIP ON COVER

Align and clip on the end cover caps, pressing in above where the clips are located.

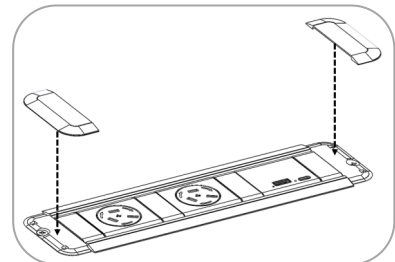

## 5 CONNECT TO POWER

Plug into power source

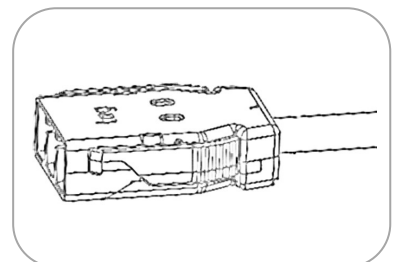

Available Power Outlets

