

100W USB-C CHARGER

USB Charging



100W USB-C CHARGER

USB Charging

The CMS 100W USB-C PD charger is the first modular charging solution for enterprise delivering optimised charging output for commercial laptops and smartphones via its USB-C/A ports.

The 100W solution features a remote power supply which reduces the length and depth required by CMS module housings, minimising the visible footprint on the workstation.



100W USB-C charging module



Athena Power Rail with Helistand
Wireless Charger and 100W USB A/C

AN01HSUAC910D**	Athena c/w 1 GPO, Helistand wireless charger (15W), USB-C/A PD fast-charge module (100W shared), 1000mm TAG lead, L3D splitter & desk clamps
AN02HSUAC910D**	Athena c/w 2 GPO, Helistand wireless charger (15W), USB-C/A PD fast-charge module (100W shared), 1000mm TAG lead, L3D splitter & desk clamps
KU01UAC910D**	KonexUS c/w 1 GPO, USB-C/A PD fast-charge outlets (100W shared) with provision for 1 x Keystone jack c/w 1000mm TAG lead with 1-in-3-out L3D splitter.
KU01UAC9G15**	KonexUS c/w 1 GPO, USB-C/A PD fast-charge outlets (100W shared) with provision for 1 x Keystone jack, c/w 1500mm lead fitted with 10A 3-pin plug
SW18BUAC9BK	100W USB-C charger, 1000mm TAG lead, 1100mm USB passthrough lead, 25mm SW18B tile
SW18BUAC9G15BK	100W USB-C charger, 1500mm 10A 3-pin plug, 1100mm USB passthrough lead, 25mm SW18B tile
SW18BUC9BK	100W Charger with 1500mm Type C adapter lead with 25mm CMS Standard Data Tile - Black
USBC9DBK	100W Charger with 1500mm Type C adapter lead for under desk mount - Black

NOTE:

** Denotes colour: black (BK), white (WT)

Colours Available

☒ Black
 ☐ White

Key features

- Below desk power supply saves space above the desk
- Powerful 100W USB-PD fast-charge via USB-C
- Capable of delivering optimum charging to most laptops and smartphones simultaneously
- Available in Athena above-desk rails and KonexUS In-Desk modules as standard

Compatible With

Above Surface



Athena Rails



Nova & Viva Rails



Zeus Rails

Recessed / In-Surface



Blinky



KonexUS



Echo Series

Below surface



100W USB-C Under-Desk Module



Accede



Executive



Neo

Soft Seating



100W USB-C Clip-in Bezel



Echo Series

Application Settings



Workstations



Meeting Rooms



Collaborative Spaces



Soft Seating



General Areas



Quiet Spaces

Assembly Options

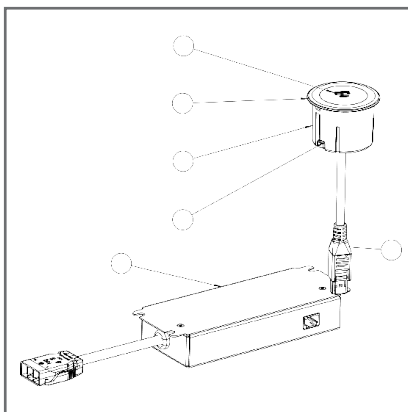

USB AC

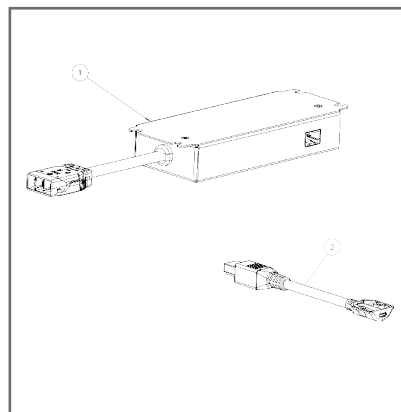

Desk Mount Lead

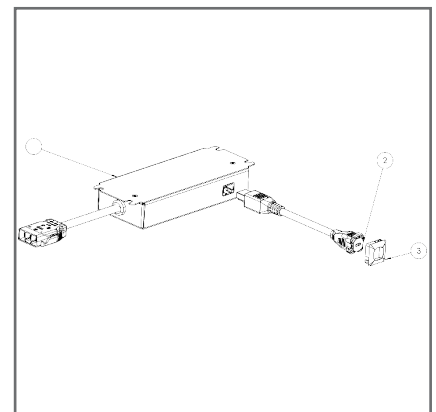

Bezel Lead

Product Specifications

Technical Data	Description
Input	100-240V AC; 50-60Hz; 1.5A
Maximum total output	100W
USB outlets	1 x Type-C, 1 x Type-A
Standby power	<0.5 Watts
In-rush current	<20A
Over voltage protection	25-27V
Short circuit protection	USB will shut down if short circuit detected and will recover once short circuit removed.
Over power protection	92-113W
Operating temperature range	0-35C
Compliance	AS/NZS 62368.1 OVCIII; CISPR32:2015
Load combinations	When only C port is used: 20V/5A; 15V/3A; 9V/3A; 5V/3A
	When only A port is used: 5V/3A; 9V/2A; 12V/1.5A
	When both C and A ports are used simultaneously: C port: 20V/3.6A; 15V/3A; 9V/3A; 5V/3A A port: 5V/3A; 9V/2A; 12V/1.5A
USB Type-C Port	
Available outputs (with no other ports in use)	20V/5A; 15V/3A; 9V/3A; 5V/3A+5V/3A;9V2A;12V/1.5A
Charging standard	Power Delivery (PD) 3.0
Protocols supported	PD3.0, PD2.0, QC3.0, QC2.0
USB Type-A Port 1	
Available outputs (with no other ports in use)	5V/3A; 9V/2A; 12V/1.5A
Protocols supported	QC3.0, QC2.0, AFC, FCP

Disclaimer: CMS has made every attempt to ensure the accuracy and reliability of the information provided in this document are correct. All information contained in this document is to be used for general guidance only. CMS reserves the right to change, delete or modify the information without notice.

Created 13/09/20

© CMS Electracom 2020

www.cmselectra.com