

# TITAN FT3TP

**LID:** ABS Plastic with recess provision for carpet tile

**UNDERCARRIAGE:** Screed Floor Assembly - 100mm Depth

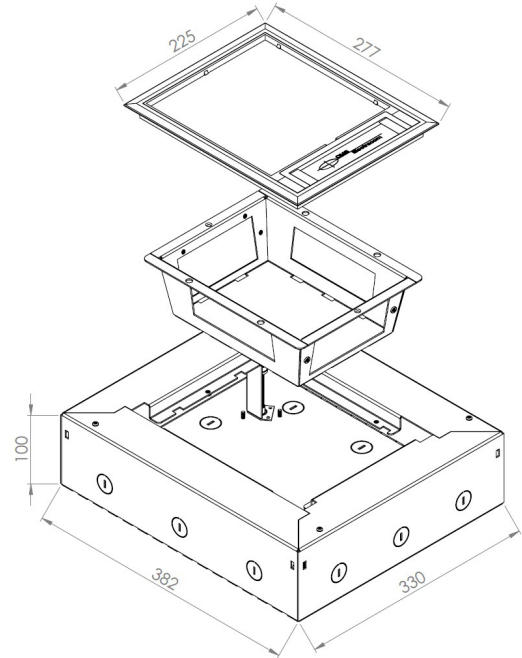

## Lid Features

- Carpet frame with recessed lid, manufactured from ABS plastic.
- 7mm lid recess for carpet tile.
- Easy-grab handle and functional cable exit when lid closed.
- Lock option available for security applications.

## Undercarriage Features

- Designed for AV Integration with Interchangeable mounting plates for Crestron, Extron, Kramer and AMX adapters.
- Wide range of modular soft/hardwired power, data and AV mounting plates.
- CAT6, 6A and 7 Compliant.
- Custom brackets & plates available.
- Designed and manufactured in Australia.

## Technical Specification

<b>Floor application</b>	Screeded concrete floor
<b>Cut-out dimension</b>	L385mm x W332mm x D100mm
<b>Lid recess dimension</b>	L200mm x W191mm x D7mm
<b>Lid specification</b>	ABS Plastic with recess provision for carpet tile insert.
<b>Undercarriage and screed box specification</b>	Undercarriage manufactured from black powder-coated mild steel. Screed box and cover manufactured from galvanised steel with knockouts for conduits.
<b>Weight rating</b>	120kg

# TITAN FT3TP

## Component List

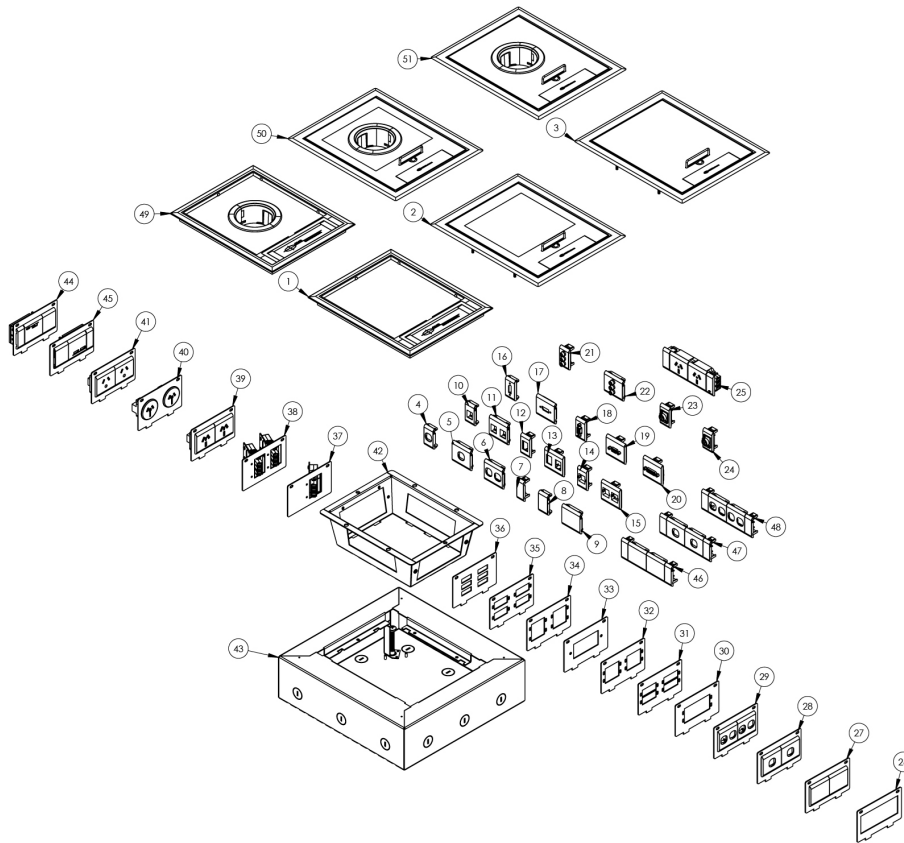

No.	Part No & Description	No.	Part No & Description
1	F3LID - APOLLO FLOORBOX PLASTIC LID	17	SW18CDP1 - 50mm TILE WITH PROVISION FOR DISPLAY PORT
2	FT3LIDSC - STAINLESS SOFT-CLOSE FB3 RECESSED LID	18	SW18BVV - 25mm TILE F/W VGA MINI GENDER BENDER
3	FTF3LIDSC - STAINLESS SOFT-CLOSE FB3 FLUSH LID	19	SW18CVV - 50mm TILE F/W VGA MINI GENDER BENDER
4	SW18B1 - 25mm SINGLE DATA TILE	20	SW18CDVI - 50mm DATA TILE - F/W DVI FEMALE CONNECTOR
5	SW18C1 - 50mm SINGLE DATA TILE	21	
6	SW18C2 - 50mm DUAL DATA TILE	22	
7	SW18A - 18mm blank tile	23	SW18BX3 - 25mm TILE F/W MINI XLR 3 PIN PLUG WITH SOLDER CUPS
8	SW18B - 25mm blank tile	24	SW18BX4 - 25mm TILE F/W MINI XLR 4 PIN PLUG WITH SOLDER CUPS
9	SW18C - 50mm BLANK TILE	25	FT1802L3H - DUAL AUTO SWITCHED POWER MODULE WITH REWIREABLE CONNECTOR
10	SW18B1K - 25mm SINGLE TILE TO SUIT KEYSTONE DATA	26	FTBPP - TITAN 100mm BLANK PLATE
11	SW18C2K - 50mm DUAL DATA TILE TO SUIT KEYSTONE JACKS	27	FTBP - BLANK PLATE F/W 2 x 50mm BLANK TILES
12	SW18B1SE - 25mm SINGLE TILE TO SUIT SIEMON DATA	28	FTD2 - ADAPTER PLATE TO SUIT 2 x 50mm SINGLE TILE (PROVISION 2 x DATA)
13	SW18C2SE - 50mm DUAL DATA TILE TO SUIT SIEMON JACKS	29	FTD4 - ADAPTER PLATE TO SUIT 2 x 50mm DUAL TILE (PROVISION 4 x DATA)
14	SW18B1SM - 25mm SINGLE TILE TO SUIT SYSTIMAX DATA	30	FTEXAAP - AAP EXTRON ADAPTER PLATE TO SUIT 1 x DOUBLE OR 2 x SINGLE MODULES
15	SW18C2SM - 50mm DUAL DATA TILE TO SUIT SYSTIMAX DATA	31	FTEXMAAP4 - TITAN FLOOR BOX MAAP EXTRON ADAPTER PLATE QUAD
16	SW18BDP1 - 25mm TILE WITH PROVISION FOR DISPLAY PORT	32	FTKRWD2 - TITAN FLOOR BOX KRAMER ADAPTER TO SUIT "W" xx DOUBLE MODULES

# TITAN FT3TP

## Component List

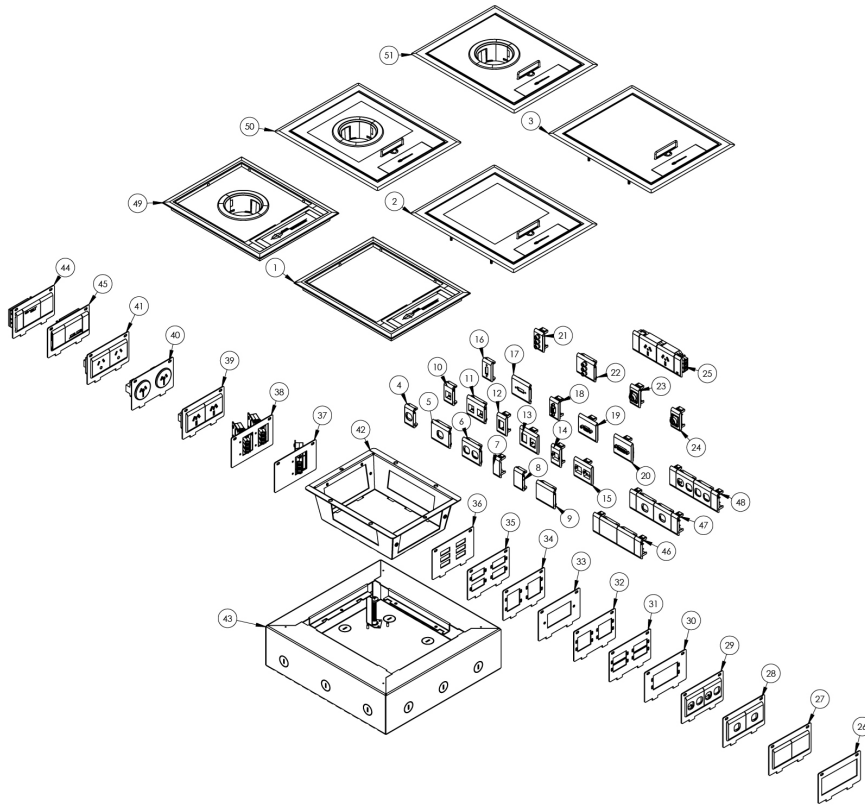

No.	Part No & Description	No.	Part No & Description
33	FTKRSV - KRAMER ADAPTER PLATE TO SUIT "SV" xx MODULES	43	FT3CH - FT3 100mm SCREED BOX
34	FTEXMAAPD2 - TITAN FLOOR BOX MAAP EXTRON ADAPTER PLATE DOUBLE	44	FTP2UACBK - TITAN FB PLATE F/W DUAL USB TYPE A&C QUALCOMM Q/CHARGER & BLANK
35	FTKRW4 - TITAN FLOOR BOX KRAMER ADAPTER PLATE TO SUIT "W" xx QUAD MODULES	45	FTP2UBK - TITAN FB PLATE F/W DUAL USB A CHARGER & BLANK
36	FTSCD - SC DUPLEX PLATE	46	FTD2BPK - TITAN 3 COMPARTMENT BLANK TILE KIT
37	FTTAG - STARTER PLATE C/W REWIREABLE SOCKET	47	FTD2C1BK - TITAN 3 COMPARTMENT 2 DATA TILE KIT
38	FTTAG2 - DOUBLE STARTER FULL PLATE - REWIREABLE SOCKETS	48	FTD2C2BK - TITAN 3 COMPARTMENT 4 DATA TILE KIT
39	FTP2 - POWER PLATE F/W 2 x AUTO SWITCHED GPO	49	FT3LIDGY-UMB - 3 COMPARTMENT PLASTIC LID WITH UMBILICAL GROMMET
40	FTP215A - TITAN PLATE TO SUIT 2 x ROUND 15A GPO	50	FT3LIDSC-UMB - 3 COMPARTMENT STAINLESS SOFT CLOSE RECESSED LID WITH UMBILICAL GROMMET
41	FTP2RE - POWER PLATE F/W 2 x AUTO SWITCHED ROUND EARTH GPO	51	FTF3LIDSC-UMB - 3 COMPARTMENT STAINLESS SOFT CLOSE FLUSH LID WITH UMBILICAL GROMMET
42	FT3UC - FT3 UNDERCARRIAGE		

# TITAN FT3TP

## Technical Specification

CMS Titan **FT3TP** screed floorbox lid, undercarriage and screed assembly. Lid manufactured from ABS plastic with 7mm recess provision for carpet/tile Insert. Undercarriage manufactured from black powder-coated mild steel. Screed box and cover manufactured from galvanised steel with knockouts for conduits. **Load capacity: 120kg**

ID No.	Part No. & Description
3	F3LID - APOLLO FLOORBOX PLASTIC LID
42	FT3UC - FT3 UNDERCARRIAGE
43	FT3CH - FT3 100mm SCREED BOX

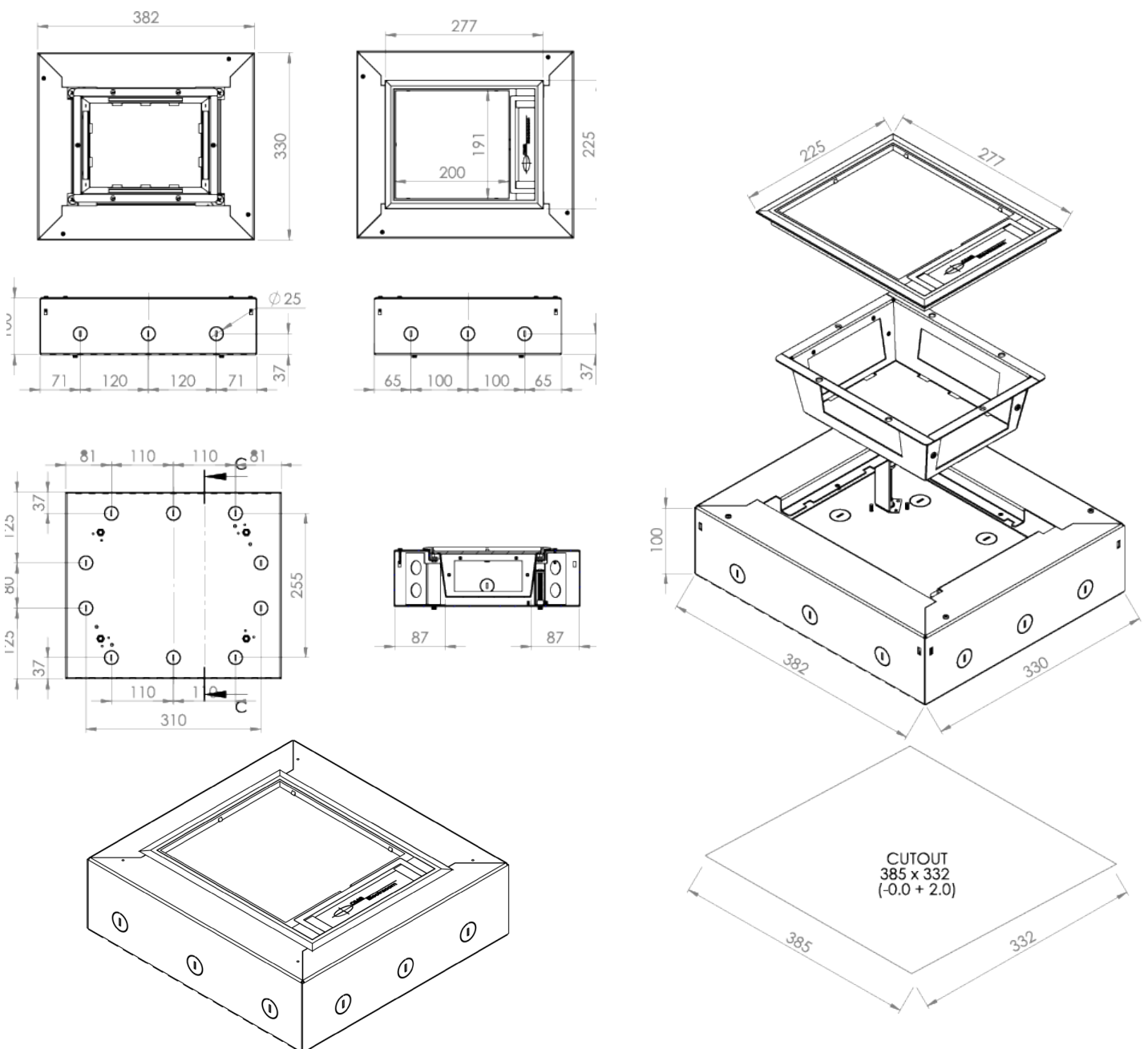

Disclaimer: CMS has made every attempt to ensure the accuracy and reliability of the information provided in this document are correct. All information contained in this document is to be used for general guidance only. CMS reserves the right to change, delete or modify the information without notice.

# TITAN FT3TP-SC

**LID:** Stainless steel with recess provision for carpet tile

**UNDERCARRIAGE:** Screed Floor Assembly - 100mm Depth

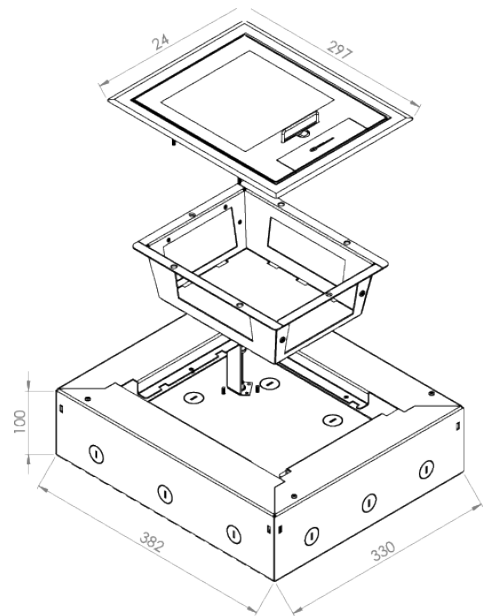

## Lid Features

- Soft-closing lid with radius edges minimises risk of accidental impact and potential cable damage
- 7mm lid recess for carpet tile.
- Easy-grab handle and functional cable exit when lid closed.
- Lock option available for security applications.

## Undercarriage Features

- Designed for AV Integration with Interchangeable mounting plates for Crestron, Extron, Kramer and AMX adapters.
- Wide range of modular soft/hardwired power, data and AV mounting plates.
- CAT6, 6A and 7 Compliant.
- Custom brackets & plates available.
- Designed and manufactured in Australia.

## TECHNICAL SPECIFICATION

<b>Floor application</b>	Screeded concrete floor
<b>Cut-out dimension</b>	L385mm x W332mm x D100mm
<b>Lid recess dimension</b>	L155mm x W148mm
<b>Lid specification</b>	Stainless steel with recess provision for carpet tile insert.
<b>Undercarriage and screed box specification</b>	Undercarriage manufactured from black powder-coated mild steel. Screed box and cover manufactured from galvanised steel with knockouts for conduits.
<b>Weight rating</b>	150kg

# TITAN FT3TP-SC

## Component List

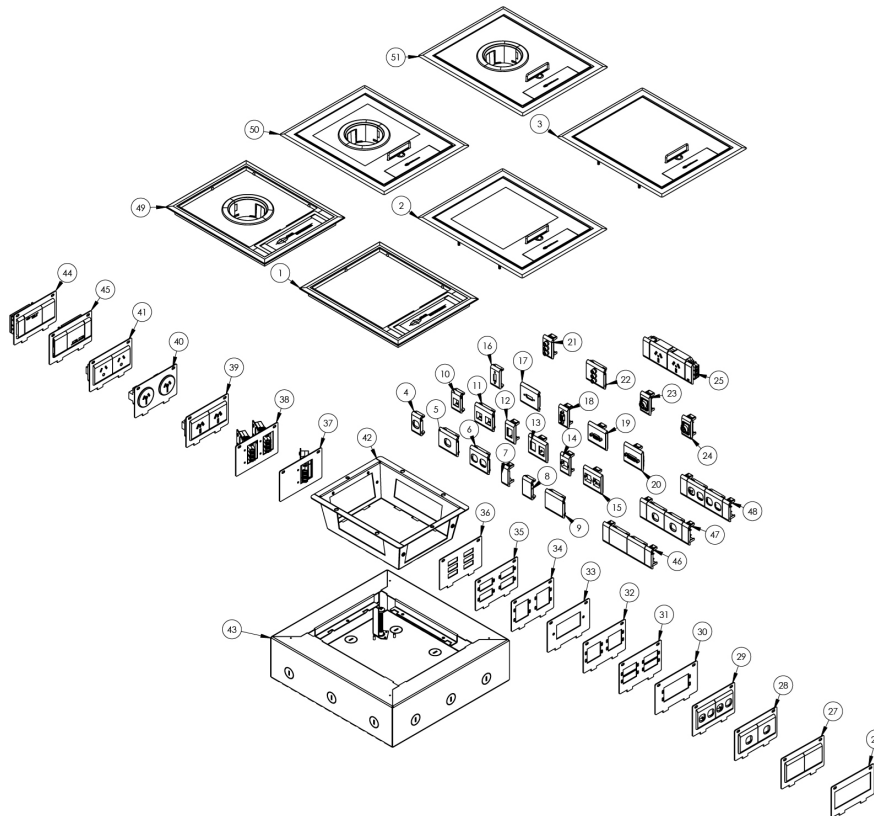

No.	Part No & Description	No.	Part No & Description
1	F3LID - APOLLO FLOORBOX PLASTIC LID	17	SW18CDP1 - 50mm TILE WITH PROVISION FOR DISPLAY PORT
2	FT3LIDSC - STAINLESS SOFT-CLOSE FB3 RECESSED LID	18	SW18BVV - 25mm TILE F/W VGA MINI GENDER BENDER
3	FTF3LIDSC - STAINLESS SOFT-CLOSE FB3 FLUSH LID	19	SW18CVV - 50mm TILE F/W VGA MINI GENDER BENDER
4	SW18B1 - 25mm SINGLE DATA TILE	20	SW18CDVI - 50mm DATA TILE - F/W DVI FEMALE CONNECTOR
5	SW18C1 - 50mm SINGLE DATA TILE	21	
6	SW18C2 - 50mm DUAL DATA TILE	22	
7	SW18A - 18mm blank tile	23	SW18BX3 - 25mm TILE F/W MINI XLR 3 PIN PLUG WITH SOLDER CUPS
8	SW18B - 25mm blank tile	24	SW18BX4 - 25mm TILE F/W MINI XLR 4 PIN PLUG WITH SOLDER CUPS
9	SW18C - 50mm BLANK TILE	25	FT1802L3H - DUAL AUTO SWITCHED POWER MODULE WITH REWIREABLE CONNECTOR
10	SW18B1K - 25mm SINGLE TILE TO SUIT KEYSTONE DATA	26	FTBPP - TITAN 100mm BLANK PLATE
11	SW18C2K - 50mm DUAL DATA TILE TO SUIT KEYSTONE JACKS	27	FTBP - BLANK PLATE F/W 2 x 50mm BLANK TILES
12	SW18B1SE - 25mm SINGLE TILE TO SUIT SIEMON DATA	28	FTD2 - ADAPTER PLATE TO SUIT 2 x 50mm SINGLE TILE (PROVISION 2 x DATA)
13	SW18C2SE - 50mm DUAL DATA TILE TO SUIT SIEMON JACKS	29	FTD4 - ADAPTER PLATE TO SUIT 2 x 50mm DUAL TILE (PROVISION 4 x DATA)
14	SW18B1SM - 25mm SINGLE TILE TO SUIT SYSTIMAX DATA	30	FTEXAAP - AAP EXTRON ADAPTER PLATE TO SUIT 1 x DOUBLE OR 2 x SINGLE MODULES
15	SW18C2SM - 50mm DUAL DATA TILE TO SUIT SYSTIMAX DATA	31	FTEXMAAP4 - TITAN FLOOR BOX MAAP EXTRON ADAPTER PLATE QUAD
16	SW18BDP1 - 25mm TILE WITH PROVISION FOR DISPLAY PORT	32	FTKRWD2 - TITAN FLOOR BOX KRAMER ADAPTER TO SUIT "W" xx DOUBLE MODULES

# TITAN FT3TP-SC

## Component List

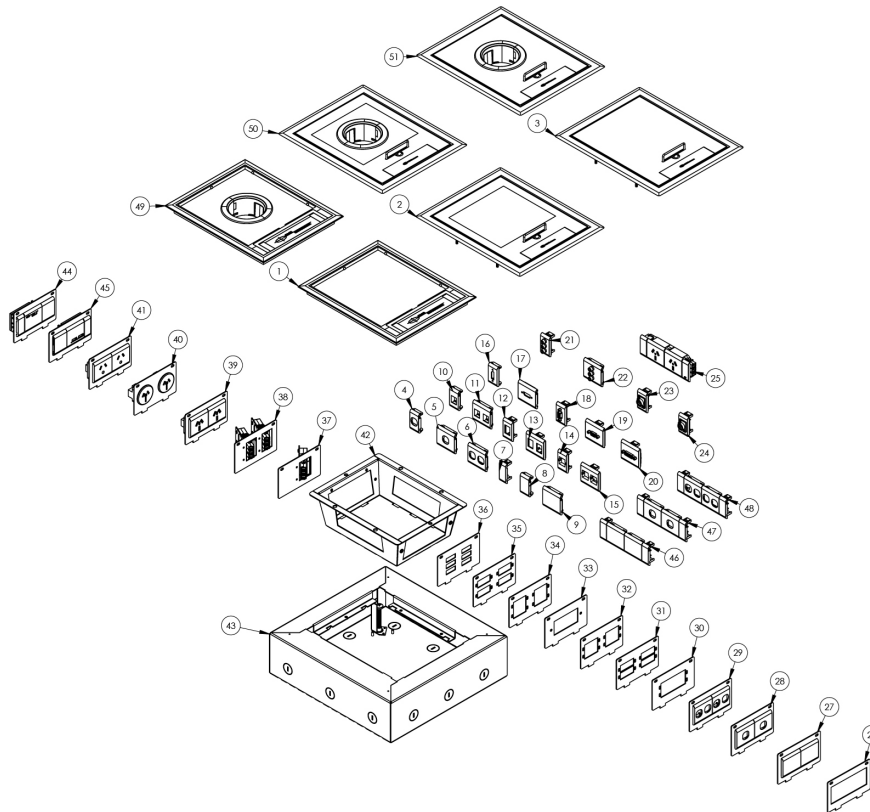

No.	Part No & Description	No.	Part No & Description
33	FTKRSV - KRAMER ADAPTER PLATE TO SUIT "SV" xx MODULES	43	FT3CH - FT3 100mm SCREED BOX
34	FTEXMAAPD2 - TITAN FLOOR BOX MAAP EXTRON ADAPTER PLATE DOUBLE	44	FTP2UACBK - TITAN FB PLATE F/W DUAL USB TYPE A&C QUALCOMM Q/CHARGER & BLANK
35	FTKRW4 - TITAN FLOOR BOX KRAMER ADAPTER PLATE TO SUIT "W" xx QUAD MODULES	45	FTP2UBK - TITAN FB PLATE F/W DUAL USB A CHARGER & BLANK
36	FTSCD - SC DUPLEX PLATE	46	FTD2BPBK - TITAN 3 COMPARTMENT BLANK TILE KIT
37	FTTAG - STARTER PLATE C/W REWIREABLE SOCKET	47	FTD2C1BK - TITAN 3 COMPARTMENT 2 DATA TILE KIT
38	FTTAG2 - DOUBLE STARTER FULL PLATE - REWIREABLE SOCKETS	48	FTD2C2BK - TITAN 3 COMPARTMENT 4 DATA TILE KIT
39	FTP2 - POWER PLATE F/W 2 x AUTO SWITCHED GPO	49	FT3LIDGY-UMB - 3 COMPARTMENT PLASTIC LID WITH UMBILICAL GROMMET
40	FTP215A - TITAN PLATE TO SUIT 2 x ROUND 15A GPO	50	FT3LIDSC-UMB - 3 COMPARTMENT STAINLESS SOFT CLOSE RECESSED LID WITH UMBILICAL GROMMET
41	FTP2RE - POWER PLATE F/W 2 x AUTO SWITCHED ROUND EARTH GPO	51	FTF3LIDSC-UMB - 3 COMPARTMENT STAINLESS SOFT CLOSE FLUSH LID WITH UMBILICAL GROMMET
42	FT3UC - FT3 UNDERCARRIAGE		

# TITAN FT3TP-SC

## Technical Specification

CMS Titan **FT3TP-SC** screed floorbox lid, undercarriage and screed assembly. Lid manufactured from stainless steel with 7mm recess provision for carpet/tile Insert. Undercarriage manufactured from black powder-coated mild steel. Screed box and cover manufactured from galvanised steel with knockouts for conduits. **Load capacity: 150kg**

ID No.	Part No. & Description
3	FT3LIDSC STAINLESS SOFT-CLOSE FB3 RECESSED LID
42	FT3UC - FT3 UNDERCARRIAGE
43	FT3CH - FT3 100mm SCREED BOX

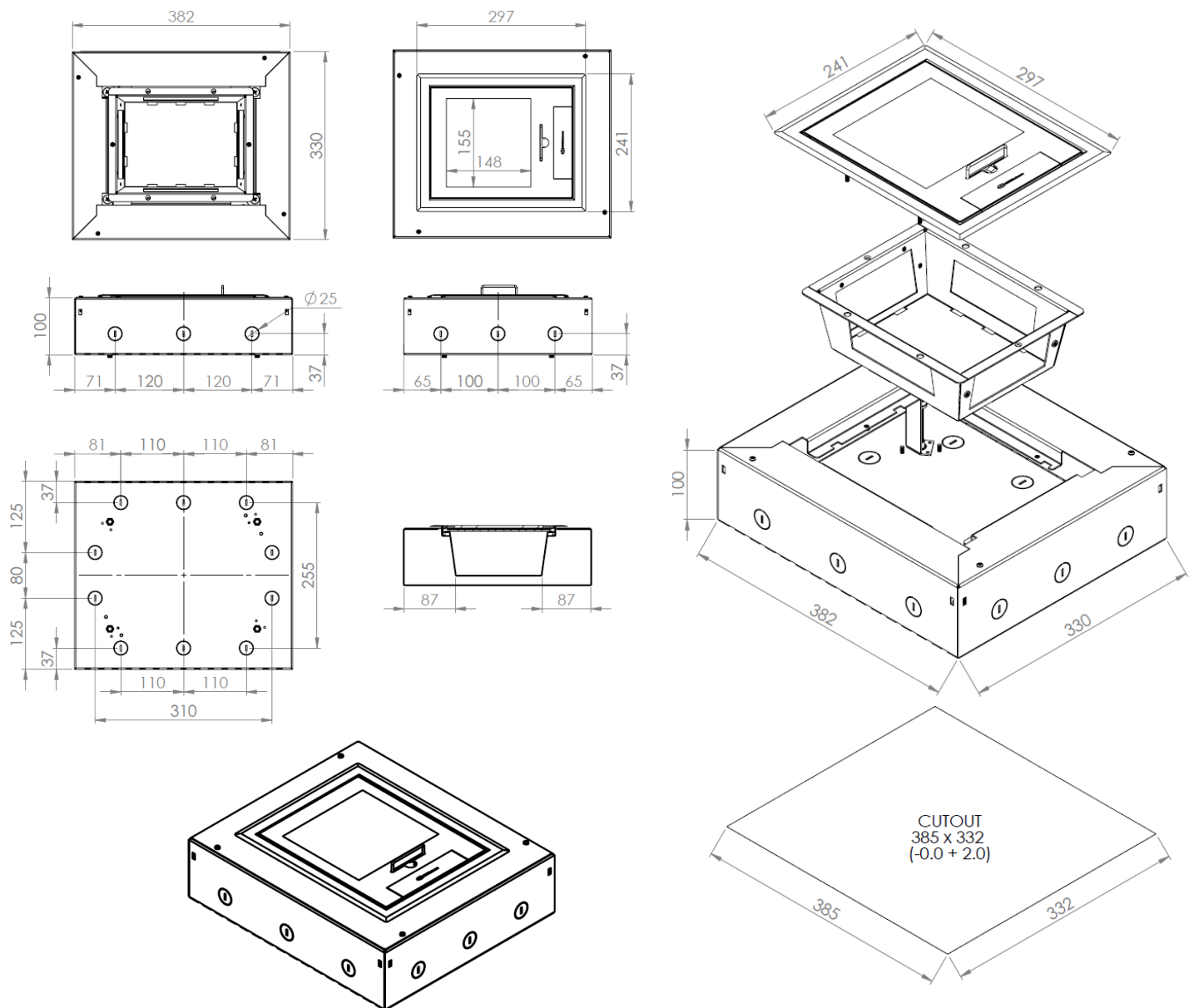

Disclaimer: CMS has made every attempt to ensure the accuracy and reliability of the information provided in this document are correct. All information contained in this document is to be used for general guidance only. CMS reserves the right to change, delete or modify the information without notice.