

CMS INSTALLATION GUIDE

SCREED BOX APPLICATION - FT4

STEP 1 -
 LEVEL AND ANCHOR SCREED BOX
 USING WIRE OR SCREWS TO PREVENT
 MOVEMENT DURING CONCRETE POUR.
 POSITION TO ENSURE TOP OF BOX IS FLUSH
 WITH FINISHED LEVEL OF CONCRETE

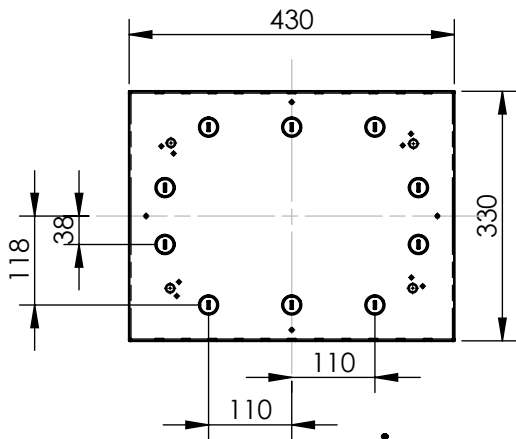
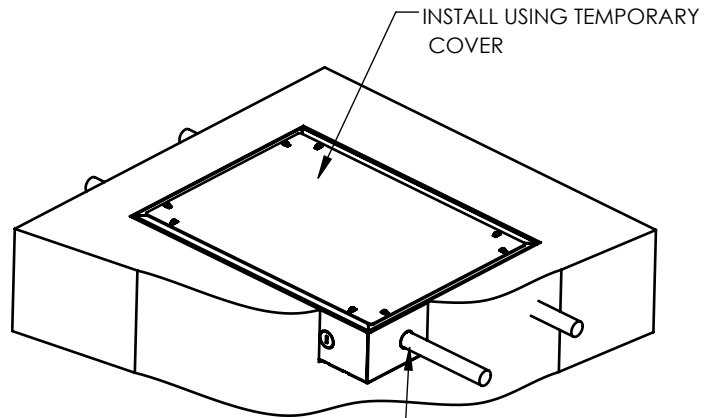

INSTALL CONDUITS THROUGH 25mm KNOCKOUTS
 AND RUN ELECTRICAL CABLES INTO SCREED BOX

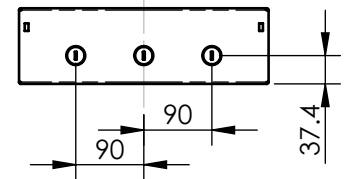
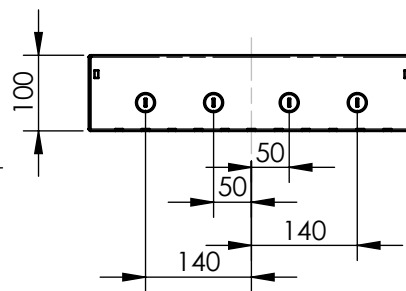

CONDUIT LOCATIONS FT4CH SCREEDBOX

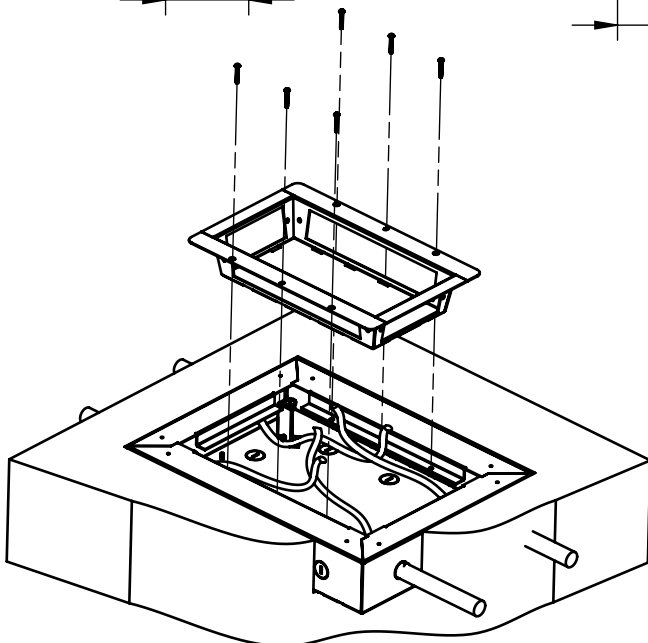

STEP 2 -
 REMOVE TEMPORARY SCREEDBOX
 COVER AND INSTALL THE UNDERCARRIAGE
 USING THE SCREWS PROVIDED

STEP 3 -
TERMINATE ALL GPO DATA AND AV
OUTLETS INTO THE MOUNTING PLATES
AND INSTALL TO THE UNDERCARRIAGE
USING THE SCREWS PROVIDED.

SECURE ALL DATA AND AV PLATES
USING THE SCREWS PROVIDED

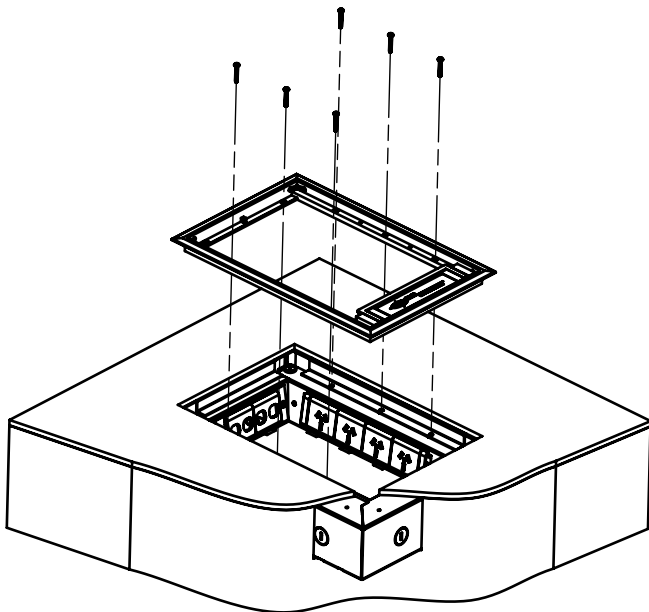
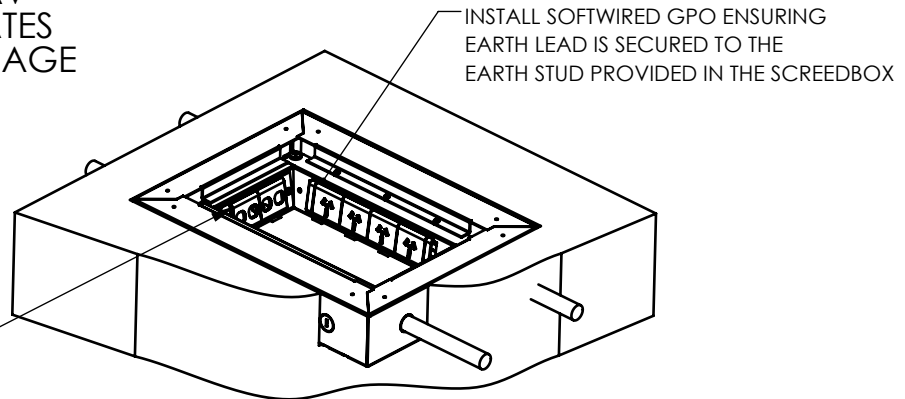

STEP 4 -
LAY CARPET AND CUT OUT HOLE FOR
THE LID TO FIT- USE CUT PEICE TO INSTALL
INTO RECESS (IF APPLICABLE)
INSTALL AND SECURE THE LID FRAME
TO THE FLOORBOX UNDERCARRIAGE
USING THE FIXING SCREWS PROVIDED

NOTE: THE LID IS ADJUSTABLE TO ACCOMODATE
VARYING CARPET THICKNESS

