

# TITAN FT4TP75

**LID:** ABS Plastic with recess provision for carpet tile

**UNDERCARRIAGE:** Low Profile Screed Floor Assembly - 80mm Depth

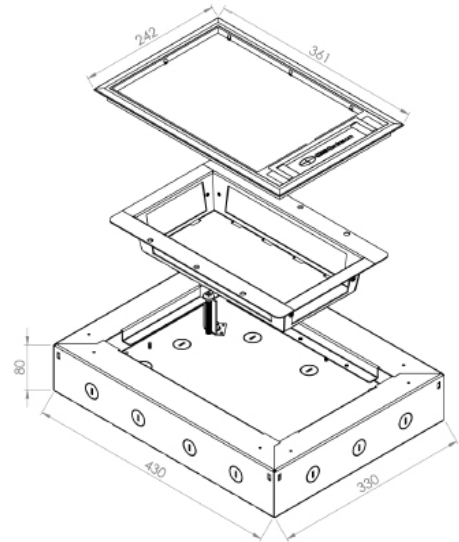

## Lid Features

- Carpet frame with recessed lid manufactured from ABS plastic.
- 7mm lid recess for carpet or vinyl tile.
- Easy-grab handle and functional cable exit when lid closed.
- Lock option available for security applications.

## Undercarriage Features

- Designed for AV Integration with Interchangeable mounting plates for Crestron, Extron, Kramer and AMX adapters.
- Wide range of modular soft/hardwired power, data and AV mounting plates.
- CAT6, 6A and 7 Compliant.
- Custom brackets & plates available.
- Designed and manufactured in Australia.

## Technical Specification

<b>Floor application</b>	Screeded concrete floor
<b>Cut-out dimension</b>	L432mm x W332mm x D80mm
<b>Lid recess dimension</b>	L285mm x W205mm x D7mm
<b>Lid specification</b>	ABS Plastic with recess provision for carpet tile insert.
<b>Undercarriage and screed box specification</b>	Undercarriage manufactured from black powder-coated mild steel. Screed box and cover manufactured from galvanised steel with knockouts for conduits.
<b>Weight rating</b>	120kg

# TITAN FT4TP75

## Component List

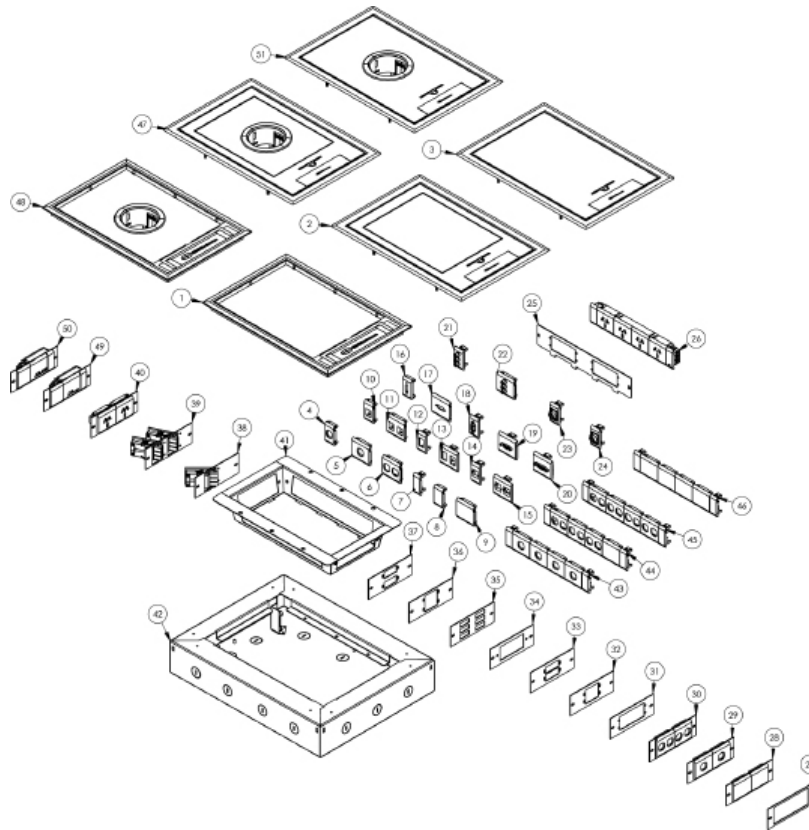

No.	Part No & Description	No.	Description
1	F4LID - APOLLO FLOORBOX PLASTIC LID	17	SW18CDP1 - 50mm TILE WITH PROVISION FOR DISPLAY PORT
2	FT4LIDSC - STAINLESS SOFT-CLOSE FB4 RECESSED	18	SW18BVV - 25mm TILE F/W VGA MINI GENDER BENDER
3	FTF4LIDSC - STAINLESS SOFT-CLOSE FB4 RECESSED FLUSH	19	SW18CVV - 50mm TILE F/W VGA MINI GENDER BENDER
4	SW18B1 - 25mm SINGLE DATA TILE	20	SW18CDVI - 50mm DATA TILE - F/W DVI FEMALE CONNECTOR
5	SW18C1 - 50mm SINGLE DATA TILE	21	
6	SW18C2 - 50mm DUAL DATA TILE	22	
7	SW18A - 18mm blank tile	23	SW18BX3 - 25mm TILE F/W MINI XLR 3 PIN PLUG WITH SOLDER CUPS
8	SW18B - 25mm blank tile	24	SW18BX4 - 25mm TILE F/W MINI XLR 4 PIN PLUG WITH SOLDER CUPS
9	SW18C - 50mm BLANK TILE	25	FTLPX2AAP - APP EXTRON PLATE TO SUIT 2 x DOUBLES OR 4 x SINGLE MODULES
10	SW18B1K - 25mm SINGLE TILE TO SUIT KEYSTONE DATA	26	FT1804L3H - QUAD AUTO SWITCHED POWER MODULE WITH REWIREABLE CONNECTOR
11	SW18CK2 - 50mm DUAL DATA TILE TO SUIT KEYSTONE JACKS	27	FTLPBPP - LOW PROFILE TITAN 100MM BLANK PLATE
12	SW18B1SE - 25mm SINGLE TILE TO SUIT SIEMON DATA	28	FTLPBP - TITAN LOW PROFILE BLANK PLATE F/W 2 x 50mm BLANK DATA TILES
13	SW18C2SE - 50mm DUAL DATA TILE TO SUIT SIEMON JACKS	29	FTDLP2 - TITAN LOW PROFILE DATA PLATE F/W 2 x 50mm SINGLE DATA PROVISION TILES
14	SW18B1SM - 25mm SINGLE TILE TO SUIT SYSTIMAX DATA	30	FTDLP4 - TITAN LOW PROFILE DATA PLATE F/W 2 x 50mm DOUBLE DATA PROVISION TILES
15	SW18C2SM - 50mm DUAL DATA TILE TO SUIT SYSTIMAX DATA	31	FTLPXAAP - AAP EXTRON ADAPTER PLATE TO SUIT 1 x DOUBLE OR 2 x SINGLES
16	SW18BDP1 - 25mm TILE WITH PROVISION FOR DISPLAY PORT	32	FTLPXMAAP2 - TITAN FLOOR BOX MAAP EXTRON PLATE SINGLE

# TITAN FT4TP75

## Component List

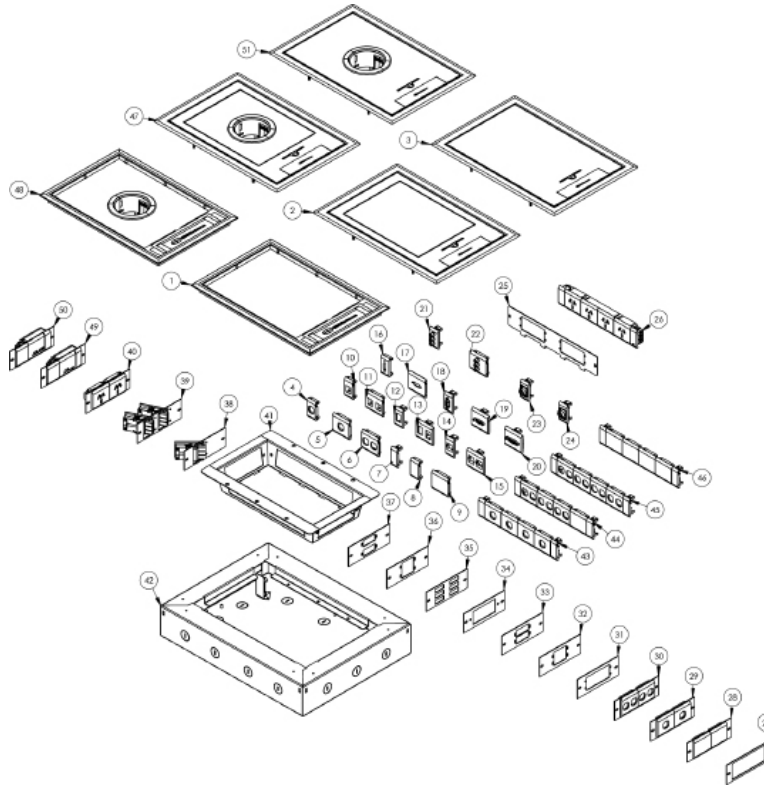

No.	Part No & Description	No.	Part No & Description
33	FTLPEXMAAPD - TITAN FLOORBOX MAAP EXTRON ADAPTER DOUBLE	43	FTD4C1BK - TITAN 4 COMPARTMENT 4 DATA TILE KIT
34	FTLPKRSV - KRAMER ADAPTER PLATE TO SUIT SV301 OR SV306	44	FTD4C2CBK - TITAN 4 COMPARTMENT 6 DATA TILE KIT
35	FTLPSCD - SC DUPLEX PLATE ADAPTER PLATE TO SUIT 75mm DEEP BOX	45	FTD8C2BK - TITAN 4 COMPARTMENT 8 DTAT TILE KIT
36	FTLPKRW2 - KRAMER ADAPTER PLATE TO SUIT "W" xx DOUBLE MODULES	45	FTD4BPBK - TITAN 4 COMPARTMENT BLANK TILE KIT
37	FTLPKRWD - KRAMER ADAPTER PLATE TO SUIT DOUBLE MODULES	47	FT4LIDSC-UMB - 4 COMPARTMENT STAINLESS SOFT CLOSE RECESSED LID AND UMBILICAL GROMMET
38	FTLPTAGBK - LOW PROFILE STARTER FULL PLATE C/W SINGLE REWIREABLE SOCKET	48	F4LIDGY-UMB - 4 COMPARTMENT PLASTIC LID WITH GALVANISED STEEL LID INSERT AND UMBILICAL GROMMET
39	FTLPTAG2 - LOW PROFILE STARTER FULL PLATE C/W DOUBLE REWIREABLE SOCKETS	49	FTLPUAC3BK - TITAN LOW PROFILE POWER PLATE F/W DUAL USB QUALCOMM TYPE A&C 30W Q/CHARGER
40	FTLPP2 - LOW PROFILE POWER PLATE F/W 2 x AUTO SWITCHED GPO	50	FTLPU2BK - TITAN FB PLATE F/W DUAL USB-A CHARGER & BLANK
41	FT4UC75 - FT4 UNDERCARRIAGE	51	FTF4LIDSC-UMB - 4 COMPARTMENT STAINLESS SOFT CLOSE FLUSH LID WITH UMBILICAL GROMMET
42	FT4CH80 - TITAN FB4 FLOOR BOX LOW PROFILE SCREED BOX		

# TITAN FT4TP75

## Technical Specification

CMS Titan FT4TP75 low profile screed floorbox lid, undercarriage and screed box assembly. Lid manufactured from ABS plastic with 7mm recess provision for carpet tile Insert. Undercarriage manufactured from black powder-coated mild steel. Screed box and cover manufactured from galvanised steel with knockouts for conduits. Load capacity: 120kg

ID No.	Part No. & Description
1	F4LID - APOLLO FLOORBOX PLASTIC LID
41	FT4UC75 - LOW PROFILE FT4 UNDERCARRIAGE
42	FT4CH80 - TITAN FT4 SCREED BOX - 80mm DEEP

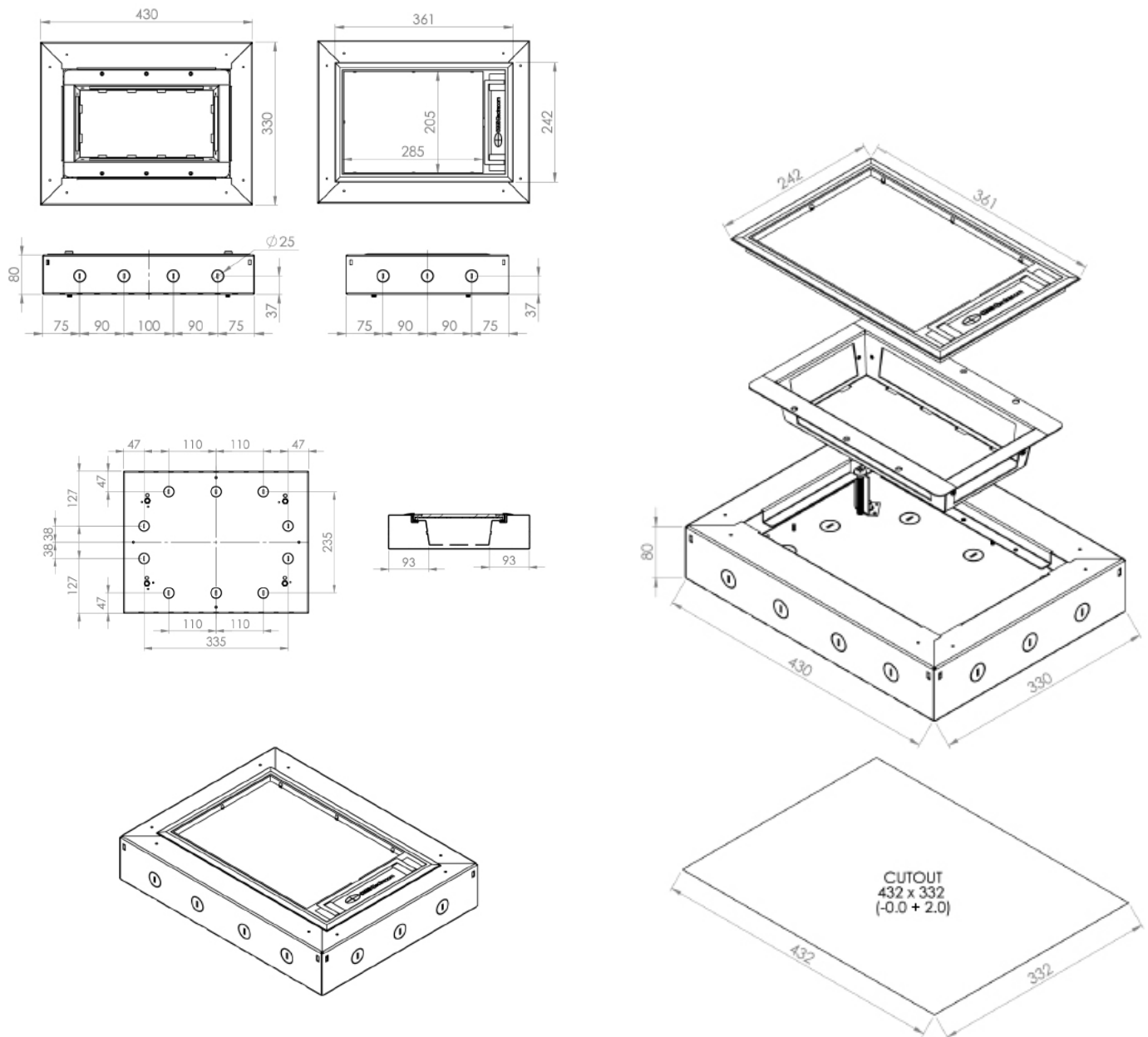

# TITAN FT4TP75-SC

**LID:** Stainless steel with recess provision for carpet tile

**UNDERCARRIAGE:** Low Profile Screed Floor Assembly - 80mm Depth

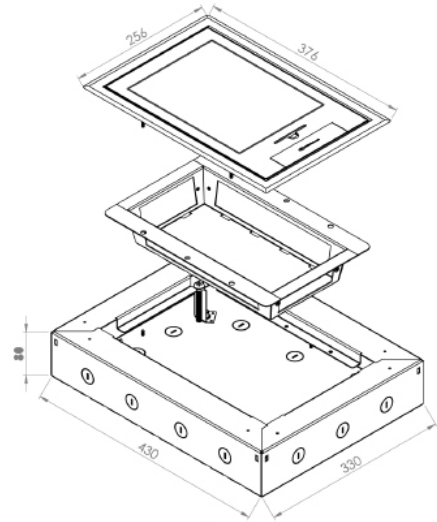

## Lid Features

- Soft-closing lid with radius edges minimises risk of accidental impact and potential cable damage.
- Easy-grab handle and functional cable exit when lid closed.
- Lock option available for security applications.

## Undercarriage Features

- Designed for AV Integration with Interchangeable mounting plates for Crestron, Extron, Kramer and AMX adapters.
- Wide range of modular soft/hardwired power, data and AV mounting plates.
- Durable galvanised screed box supplied with cover.
- CAT6, 6A and 7 Compliant.
- Custom brackets & plates available.
- Designed and manufactured in Australia.

## Technical Specification

<b>Floor application</b>	Screeded concrete floor
<b>Cut-out dimension</b>	L432mm x W332mm x D80mm
<b>Lid recess dimension</b>	L230mm x W174mm x D7mm
<b>Lid specification</b>	Stainless steel with recess provision for carpet tile
<b>Undercarriage and screed box specification</b>	Undercarriage manufactured from black powder-coated mild steel. Screed box and cover manufactured from galvanised steel with knockouts for conduits
<b>Weight rating</b>	150kg

# TITAN FT4TP75-SC

## Component List

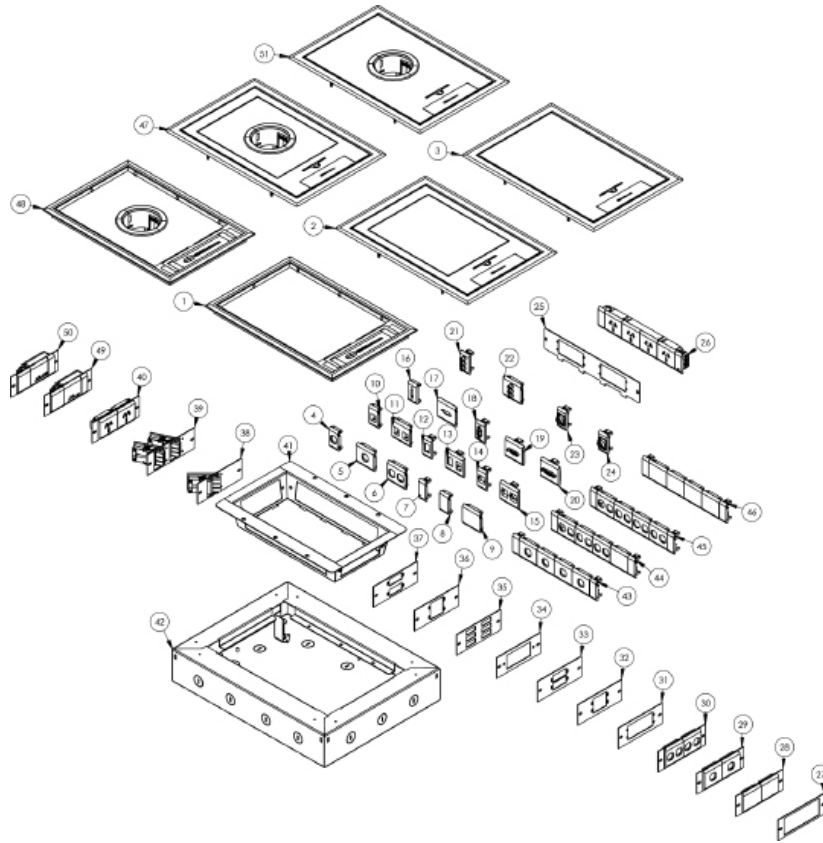

No.	Part No & Description	No.	Part No & Description
1	F4LID - APOLLO FLOORBOX PLASTIC LID	17	SW18CDP1 - 50mm TILE WITH PROVISION FOR DISPLAY PORT
2	FT4LIDSC - STAINLESS SOFT-CLOSE FB4 RECESSED	18	SW18BVV - 25mm TILE F/W VGA MINI GENDER BENDER
3	FTF4LIDSC - STAINLESS SOFT-CLOSE FB4 RECESSED FLUSH	19	SW18CVV - 50mm TILE F/W VGA MINI GENDER BENDER
4	SW18B1 - 25mm SINGLE DATA TILE	20	SW18CDVI - 50mm DATA TILE - F/W DVI FEMALE CONNECTOR
5	SW18C1 - 50mm SINGLE DATA TILE	21	
6	SW18C2 - 50mm DUAL DATA TILE	22	
7	SW18A - 18mm blank tile	23	SW18BX3 - 25mm TILE F/W MINI XLR 3 PIN PLUG WITH SOLDER CUPS
8	SW18B - 25mm blank tile	24	SW18BX4 - 25mm TILE F/W MINI XLR 4 PIN PLUG WITH SOLDER CUPS
9	SW18C - 50mm BLANK TILE	25	FTLPX2AAP - APP EXTRON PLATE TO SUIT 2 x DOUBLES OR 4 x SINGLE MODULES
10	SW18B1K - 25mm SINGLE TILE TO SUIT KEYSTONE DATA	26	FT1804L3H - QUAD AUTO SWITCHED POWER MODULE WITH REWIREABLE CONNECTOR
11	SW18CK2 - 50mm DUAL DATA TILE TO SUIT KEYSTONE JACKS	27	FTLPBPP - LOW PROFILE TITAN 100MM BLANK PLATE
12	SW18B1SE - 25mm SINGLE TILE TO SUIT SIEMON DATA	28	FTLPBP - TITAN LOW PROFILE BLANK PLATE F/W 2 x 50mm BLANK DATA TILES
13	SW18C2SE - 50mm DUAL DATA TILE TO SUIT SIEMON JACKS	29	FTDLP2 - TITAN LOW PROFILE DATA PLATE F/W 2 x 50mm SINGLE DATA PROVISION TILES
14	SW18B1SM - 25mm SINGLE TILE TO SUIT SYSTIMAX DATA	30	FTDLP4 - TITAN LOW PROFILE DATA PLATE F/W 2 x 50mm DOUBLE DATA PROVISION TILES
15	SW18C2SM - 50mm DUAL DATA TILE TO SUIT SYSTIMAX DATA	31	FTLPXAAP - AAP EXTRON ADAPTER PLATE TO SUIT 1 x DOUBLE OR 2 x SINGLES
16	SW18BDP1 - 25mm TILE WITH PROVISION FOR DISPLAY PORT	32	FTLPXMAAP2 - TITAN FLOOR BOX MAAP EXTRON PLATE SINGLE

# TITAN FT4TP75-SC

## Component List

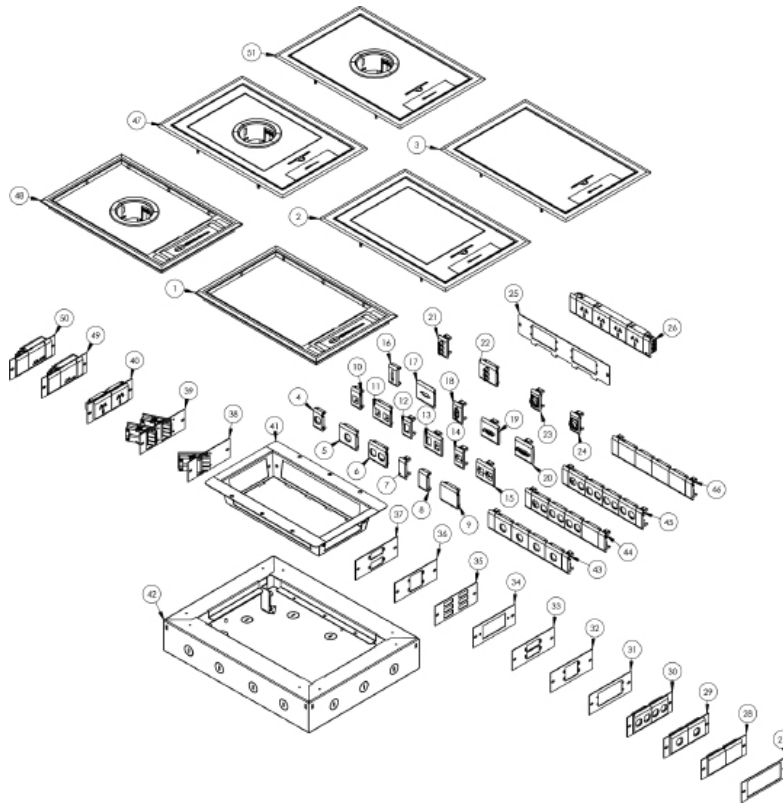

No.	Part No & Description	No.	Part No & Description
33	FTLPEXMAAPD - TITAN FLOORBOX MAAP EXTRON ADAPTER DOUBLE	43	FTD4C1BK - TITAN 4 COMPARTMENT 4 DATA TILE KIT
34	FTLPKRSV - KRAMER ADAPTER PLATE TO SUIT SV301 OR SV306	44	FTD4C2CBK - TITAN 4 COMPARTMENT 6 DATA TILE KIT
35	FTLPSCD - SC DUPLEX PLATE ADAPTER PLATE TO SUIT 75mm DEEP BOX	45	FTD8C2BK - TITAN 4 COMPARTMENT 8 DTAT TILE KIT
36	FTLPKRW2 - KRAMER ADAPTER PLATE TO SUIT "W" xx DOUBLE MODULES	46	FTD4BPBK - TITAN 4 COMPARTMENT BLANK TILE KIT
37	FTLPKRWD - KRAMER ADAPTER PLATE TO SUIT DOUBLE MODULES	47	FT4LIDSC-UMB - 4 COMPARTMENT STAINLESS SOFT CLOSE RECESSED LID AND UMBILICAL GROMMET
38	FTLPTAGBK - LOW PROFILE STARTER FULL PLATE C/W SINGLE REWIREABLE SOCKET	48	F4LIDGY-UMB - 4 COMPARTMENT PLASTIC LID WITH GALVANISED STEEL LID INSERT AND UMBILICAL GROMMET
39	FTLPTAG2 - LOW PROFILE STARTER FULL PLATE C/W DOUBLE REWIREABLE SOCKETS	49	FTLPUAC3BK - TITAN LOW PROFILE POWER PLATE F/W DUAL USB QUALCOMM TYPE A&C 30W Q/CHARGER
40	FTLPP2 - LOW PROFILE POWER PLATE F/W 2 x AUTO SWITCHED GPO	50	FTLPU2BK - TITAN FB PLATE F/W DUAL USB-A CHARGER & BLANK
41	FT4UC75 - FT4 UNDERCARRIAGE	51	FTF4LIDSC-UMB - 4 COMPARTMENT STAINLESS SOFT CLOSE FLUSH LID WITH UMBILICAL GROMMET
42	FT4CH80 - TITAN FB4 FLOOR BOX LOW PROFILE SCREED BOX		

# TITAN FT4TP75-SC

## Technical Specification

CMS Titan FT4TP75-SC low profile screed floorbox lid, undercarriage and screed box assembly. Lid manufactured from recessed edge with soft-closing lid with radius edges minimises risk of accidental impact and potential cable damage. Undercarriage manufactured from black powder-coated mild steel. Screed box and cover manufactured from galvanised steel with knockouts for conduits. Load capacity: 150kg

ID No.	Part No. & Description
2	FT4LIDSC - STAINLESS SOFT-CLOSE FB4 RECESSED LID
41	FT4UC75 - FT4 UNDERCARRIAGE
42	FT4CH80 - TITAN FB4 FLOOR BOX LOW PROFILE SCREED BOX

