

# WG & WGE WIRE GRID

## 1 SECURE THE CLIP

Screw mounting brackets to under side of desk

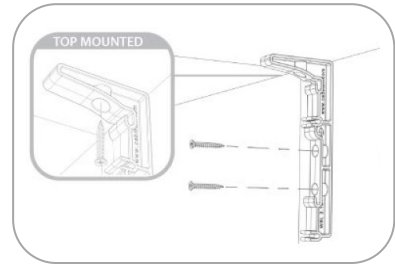

## 2 CLIP IN BASKETS

Slide the top of the wire grid in the slot, then click the bottom of the wire grid into groove of the bracket

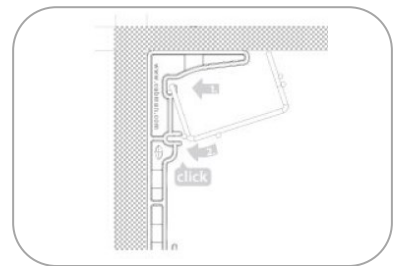

## 3 CONFIRM IT IS IN RIGHT POSITION

Confirm the Wire grid is in the right position. Clips can be moved to any section.

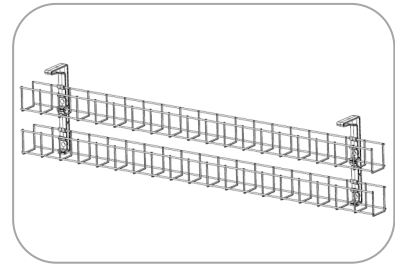

## 4 FEEDING CABLES THROUGH AND INSTAL DATA TILES

Data tiles clip onto the wire grid on the top and bottom into a 50mm section.

Feed cables into the wire grid and terminate Data Jack into the Data tile

